

LED source for the starry sky with Bluetooth, RGBW 6W

Reference: AM9723

EAN13: -

UPC: 94054210

Product attributes:

Product features:

Light color: RGBW

Input voltage: 12V DC

Performance: 6 W

Inner diameter of the gland: 16-21mm

Outlet: 1x PG25



Product description:

6W RGBW starry sky source with RF remote control. Simple color change thanks to the wireless RF controller with 5 modes (one color, flashing 7 colors, strobe 3 colors, gradual flashing colors, slow blending of 7 colors) for all modes, the speed or brightness can be adjusted. Compact size suitable for car starry sky installations.

Power: 6W

Control by RF controller or Bluetooth.

Dimming option: YES

Light source size: 137x35x35mm

Source protection: IP22

Input voltage: 12V DC

Package contents:

1x 16W light source

1x RF remote control

1x socket source from 230V to 12V

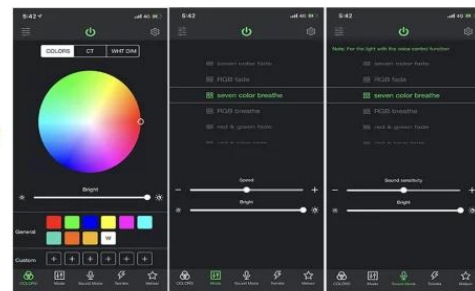

- STATIC MODE**
- DYNAMIC MODE**
- SOUND CONTROL MODE**
- ① More Than 16 Million of Colors
 - ② Brightness control from 1%-100%
 - ③ Long-range control convenient and quick
 - ④ Multi modes can be controlled by one APP
 - ⑤ Sound activated to change color according to rhythm of music.
 - ⑥ Several light engines could be controlled by one APP at a time.

Install Star Lights On Car Roof

